

APRIL 2024



MONTHLY NEWSLETTER

THE CAMPUS | **at SGV**



THECAMPUSATSGV.com



Welcome

704,620 square foot, low-rise suburban office campus

ABOUT

Comprised of three separate buildings, the campus was developed in 1989 by Home Savings of America and originally served as their state of the art corporate headquarters.

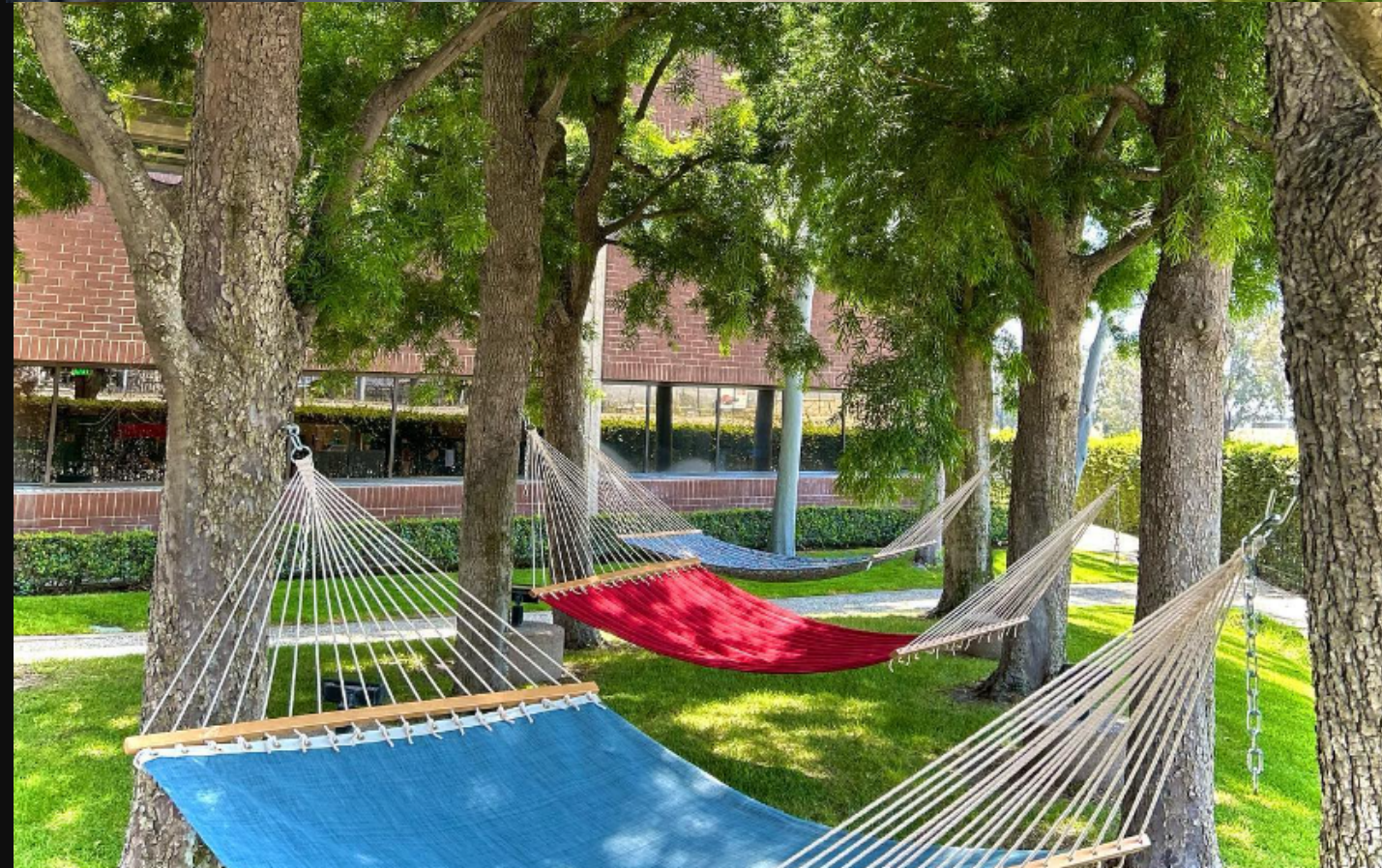

Social Media @thecampusatsgv

FOR MANAGEMENT:



+626-813-2525

CAMPUS AMENITIES

EXPERIENCE ALL THAT THE CAMPUS HAS TO OFFER

AVAILABLE DAILY

Monday - Friday

ENJOY THE CAMPUS TODAY!



BIKE SHARE PROGRAM



HAMMOCK GARDEN



GYM FACILITY

- HAMMOCK GARDEN
- BIKE SHARE PROGRAM
- PUTTING GREEN
- RAQUETBALL COURTS
- ARCADE
- BASKETBALL COURTS
- WALKING PATH

- FILTERED WATER STATIONS
- GYM FACILITY
- CONFERENCE ROOMS
- EV-CHARGING
- LOCKER ROOMS
- YOGA
- ON-SITE CAFE - TRIMANA



THE CAMPUS | at SGV

COOKIE THURSDAY

Join us every Thursday for
the month of April for
Cookie Thursday's.

All employees are
welcome to stop by the
Property Management
Office for a delicious
treat...while supplies last!

Location: Suite A-110

Time: 12:00PM-1:00PM

THECAMPUSATSGV.com

EARTH DAY EVENT

**JOIN US ON
THURSDAY
APRIL 18TH 2024**

THE CAMPUS | at SGV



CALLING ALL TENANTS

Please join us on Thursday, April 18th for The Campus at SGV's Earth Day Event!

We will be giving away goodies, gift cards and giving pointers on ways to reach environmental sustainability.

EVENT DETAILS

 **11:30 AM - 1:00 PM**

 **4910 Courtyard near Putting Green**



THECAMPUSATSGV.com



Hosted by
7Elements Yoga

Yoga Class

Join us Every Tuesday
@12:15 PM

SIGN UP

Duration: 50 Minutes

FREE TO SIGN UP

Located at the 4900 Bldg Racquetball Court

“weather dependent - will be relocated to
4900 Guest Lot”

WEBSITE

Yoga Session that blends
movement with meditation to
clear your head and recharge
your body.





**3 CHICKEN
TAQUITOS
WITH
GUACAMOLE
\$7.49**

TRIMANA CAFE

4910 BUILDING

Everything Prepared with High Quality, Rich Taste and Made Fresh on Order.



HOURS

7:00A.M. - 3:00P.M. | Monday - Friday





GYM FACILITY

START YOUR JOURNEY WITH US

HOURS : 6AM - 12AM DAILY

LOCATION : 4900 RIVERGRADE RD. - B POD

[VISIT WEBSITE](#)



REACH YOUR BODY GOALS

- The Fitness Center is for the exclusive use of tenants and employees only. NO Guests Allowed.
 - Waivers must be signed in order to be granted access to the fitness center.
 - Food and beverages not allowed. Water bottles only.
 - Shoes and shirts must be worn at all times.
 - Tenants and Employees must carry a towel and wipe down equipment after use.
 - Use of the equipment in the fitness center is at your own risk.
- 



NEED A WORK BREAK? EXPLORE STUDIO 89'



Calling all tenants!
Discover non-stop fun at our spectacular arcade space. Unleash your inner gamer with basketball, foosball, ping pong and more. come on down and let the games begin.

HOURS : M- F | 8AM - 5PM



SHOOT TO WIN

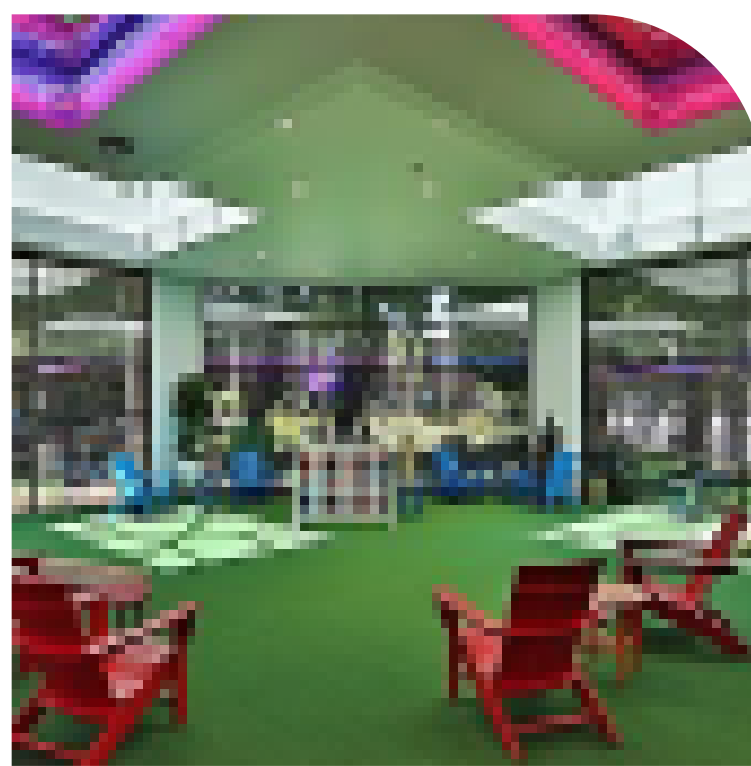

LOUNGE



FOOSEBALL

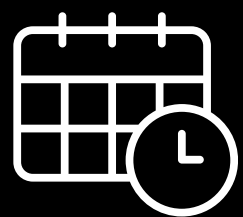

AVAILABLE DAILY



The Campus | at SGV
4900 Rivergrade Rd.

- Download the movatic app and create an account
- Scan the QR code on the bike
- Enjoy your ride! Be sure to follow all rules of the road, & always ride in control
- Lock your bike to a station and select end rental in app

BIKE SHARE PROGRAM

**RIDE
TODAY!**

 (313) 217 - 9220

 support@tandem-mobility.com

- A** 4 Pedestals, 8 Ports
- B** 8 Pedestals, 16 Ports
- C** 5 Pedestals, 10 Ports



***Each pedestal has two ports.**

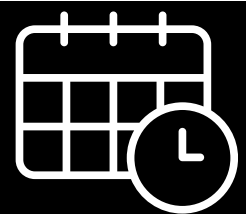

AVAILABLE DAILY



The Campus | at SGV

- Sign up for ChargePoint or log in to your account in the app
- To request to connect, open the main menu then click "Account"
- Click "Connections"
- Then tap the "Browse Connections" buttons
- Search for an organization by name or enter a connection code (Please contact MGMT office for connection code)

Management Office | (626) 813 - 2525

EV CHARGING



chargepoint

CHARGE TODAY!

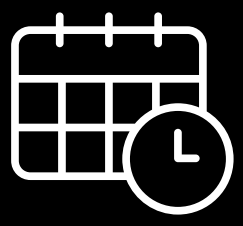

AVAILABLE DAILY



The Campus | at SGV

chargepoint.

EV CHARGING



Parking at EV Stations During Charging:

- The EV charging stations are exclusively designated for **electric vehicles only**.
- Please do not park at the EV stations unless your vehicle is actively charging.

Prompt Removal After Charging:

- If your vehicle has completed charging, we kindly ask that you move your vehicle to make space for others who may need to charge.

Penalties for Unauthorized Parking:

- Vehicles parked at the EV stations that are not charging or after completing charging, will be subject to penalties.
- Vehicles will be ticketed or subject to towing without prior notice, at owner's expense.

Courtesy to Fellow EV Users:

- Please be courteous to other EV users and avoid taking up charging spaces unnecessarily. Be mindful of the needs of others who may need access to the charging stations.

Reporting Issues:

- If you encounter any issues with the EV charging stations, such as malfunctions or damage, please report them immediately to the Property Management team.
- The Property Management Office is located in the 4900 Building, Suite A110. You may also reach us at (626) 813-2525 or phoebe.lo@cbre.com.

**CHARGE
TODAY!**



AMENITIES MENU

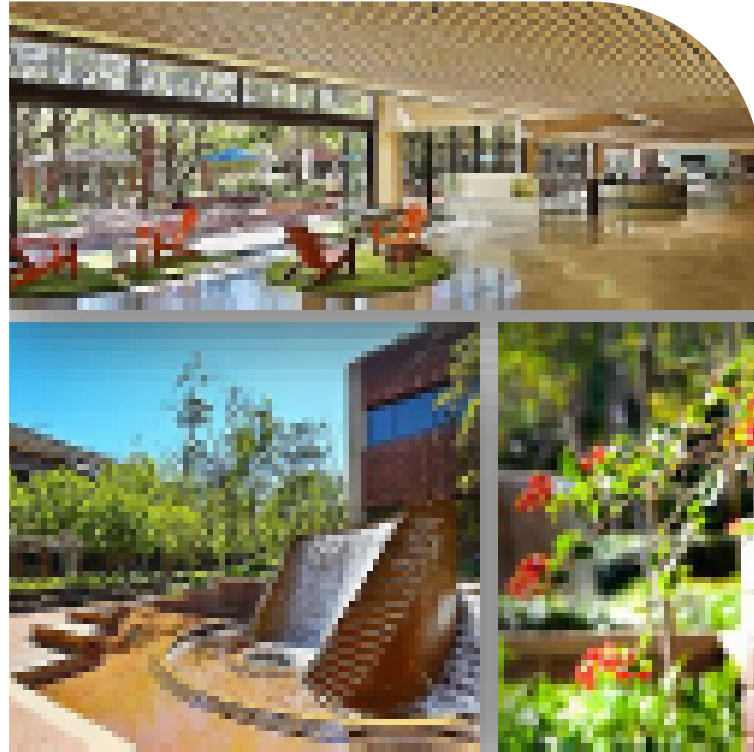

THE GARDEN

Location: 4900, B-Pod East
Lounge: \$50/hr or \$1000/day
Courtyard: \$125/hr or \$850/day
Both: \$150/hr or \$1000/day

Lounge Capacity: 32
Courtyard Capacity: 72
Total Capacity: 104

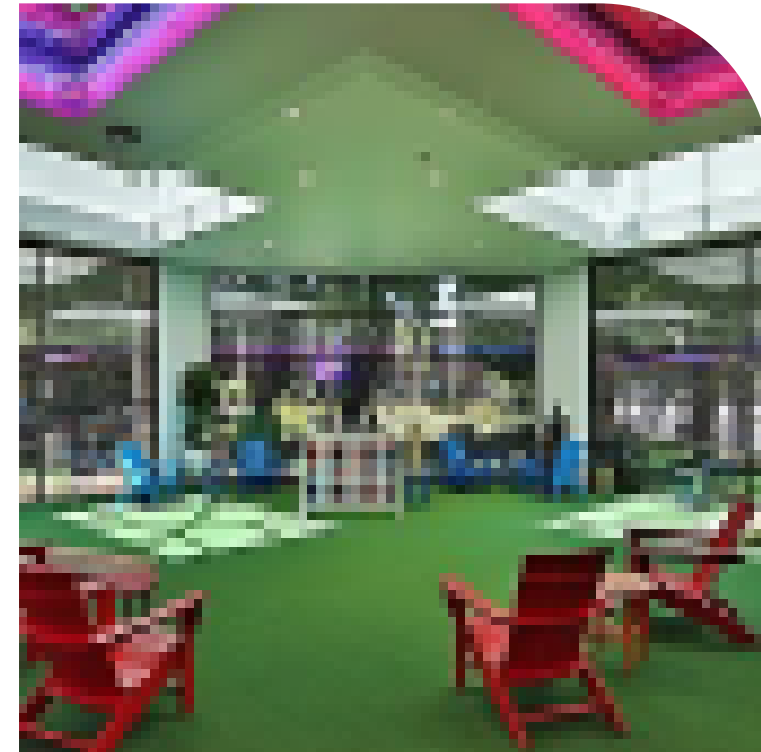

STUDIO 89'

Location: 4910, near Trimana
\$90/hr or \$700/day

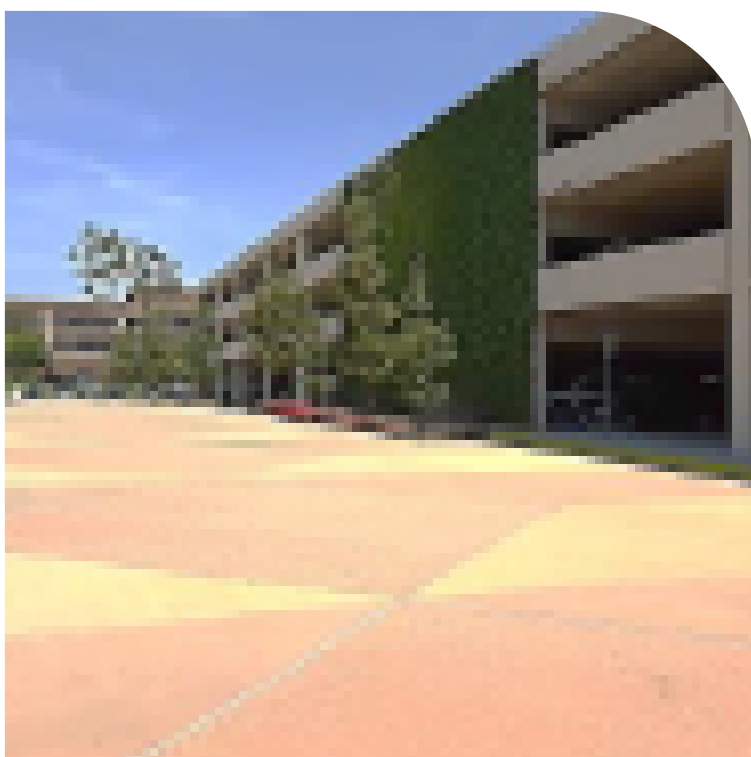

PARKADE

Location: 4920 Garage
\$75/hr or \$500/day

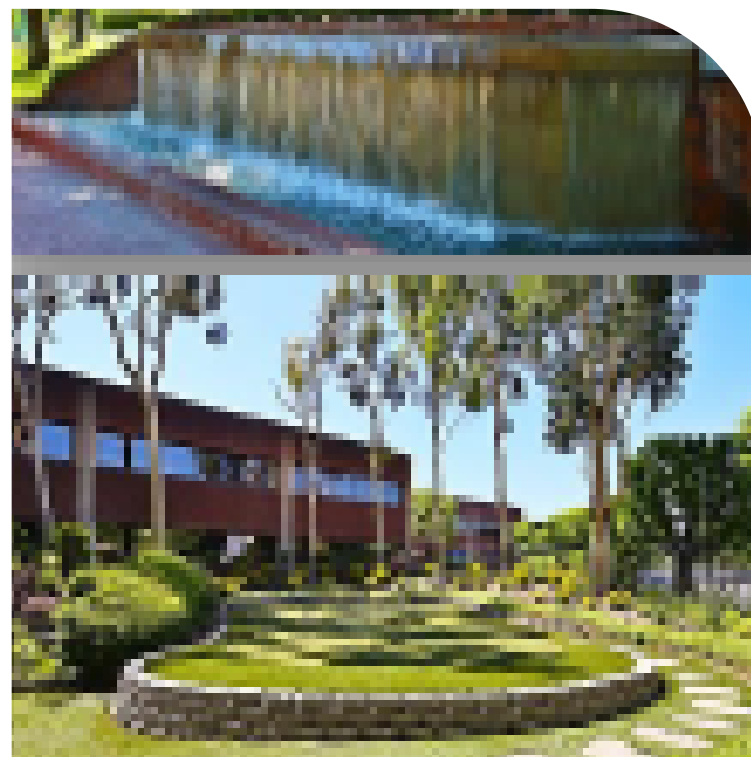

FOUNTAIN TERRACE

Location: 4910, outside
Trimana
\$90/hr or \$700/day
Capacity: 60



FORUM HALL

Location: 4910, near Trimana
\$85/hr or \$500/day
Capacity: 30

Capacity calculated based on available seating. Extra seating and special accommodations may be granted upon request. Please reserve at least two weeks in advance prior to your event. Cancellations made less than 48 hours before the event will receive 50% refund.

THE CAMPUS | at SGV

CONNECT WITH US

Building Management Office

Location : 4900 Rivergrade Rd,
Irwindale, Ca 91706

Suite : A110

Office Phone : (626) 813 - 2525

Hours : Mon - Fri 8:00 Am - 5:00 Pm

Visit our Website Below

[CLICK HERE](#)

THECAMPUSATSGV.COM



@THECAMPUSATSGV